

# PRODUCT DATA SHEET

## EMPTY CONTROL BOXES



### DESCRIPTION

Ergonomic use and high impact resistance.  
High protection class body and maximum resistance to environmental conditions.  
Ease of direction determination thanks to arrow labels.  
Ease of assembly.

### FEATURES

- Suitable for  $\varnothing 22$  mm buttons
- Strong resistance against mechanical strokes
- IP65 with suitable buttons

# PRODUCT DATA SHEET

## EMPTY CONTROL BOXES

### SECTIONS AND DIMENSIONS

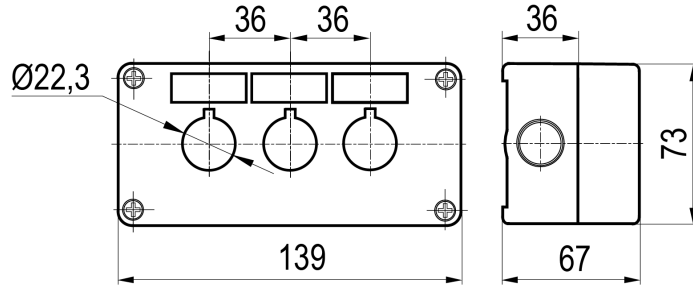

PRODUCT CODE	DESCRIPTION	COLOUR
GBK - 3	3 Hole Empty Control Box	Yellow-Black